



Industrial



Auto



Wood



Air Solutions, Inc.
40 Avebury Cove
Eads, TN 38028
Ph 901-290-5090
Fx 901-290-5091

website: www.airsolutions.us

EZ CLASSIC CROSSDRAFT

- EZ TO INSTALL
- EZ TO OPERATE
- EZ TO MAINTAIN
- EZ TO QUICK SHIP

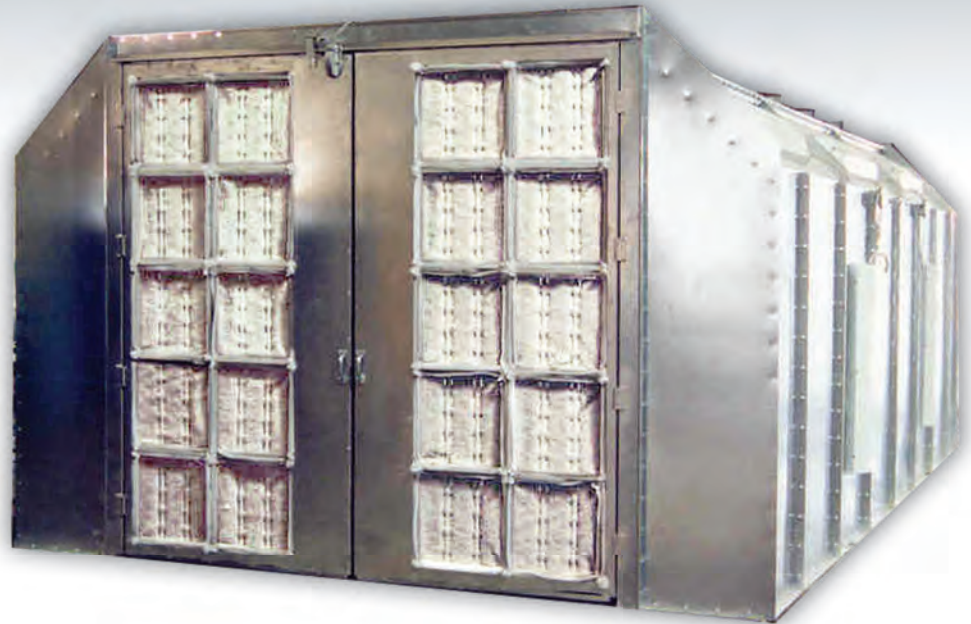
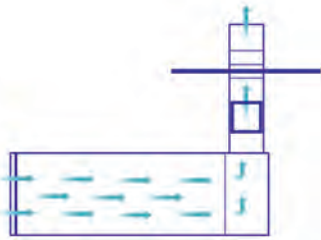

- Control panel and other electric components can be purchased separately
- ETL listed when optional when control panel is added



- Industry-leading light levels
- Spray booth specific, dual voltage T-8 32-watt light fixtures
- Quality brand-name tubeaxial fans and motors
- Air solenoid valve



- Windowed personnel access doors are pre-hung in a heavy gauge galvanized steel frame for easy installation.
- Product doors are field hung on slotted hinges to facilitate installation on uneven floors

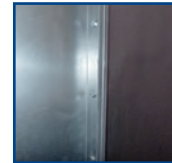

- Constructed from 18 gauge, prime-quality steel
- All panels and support members are precision punched for easy nut and bolt assembly
- 5/16" bolt with self locking nuts

OVERVIEW

The Col-Met EZ Crossdraft Booth intakes fresh air through filters in the product doors. The clean, filtered air is drawn through the booth and exhausted through a filter system at the opposite end. This type of spray booth makes efficient use of shop space, and is available in solid back, drive through and reverse flow designs. Reverse flow booths intake air through filters in the back wall. The solid-faced product access doors are at the exhaust end of the booth. This provides cleaner intake filtering and better control of shop dust that might be tracked in at the product entrance. This booth also available in either drive-through or solid back configurations.

LIGHTING FEATURES

Bright, full booth illumination is provided by ten 48" four-tube, 32-watt fluorescent light fixtures in the angled ceiling panels and side walls. Each is sealed behind clear, tempered safety glass. All fixtures are UL listed and approved for their intended use and placement.



Industrial



Auto



Wood



Air Solutions, Inc.

40 Avebury Cove

Eads, TN 38028

Ph 901-290-5090

Fx 901-290-5091

website: www.airsolutions.us

EZ CLASSIC CROSSDRAFT

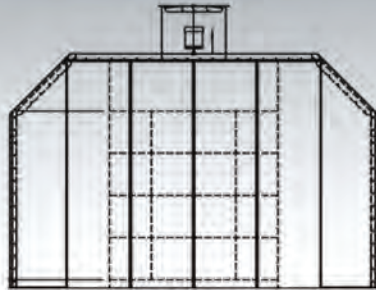

END VIEW @ CHAMBER

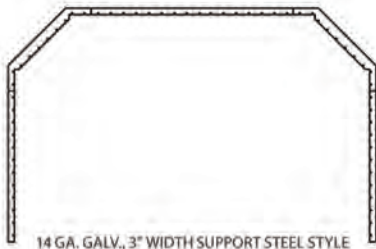

14 GA. GALV., 3" WIDTH SUPPORT STEEL STYLE

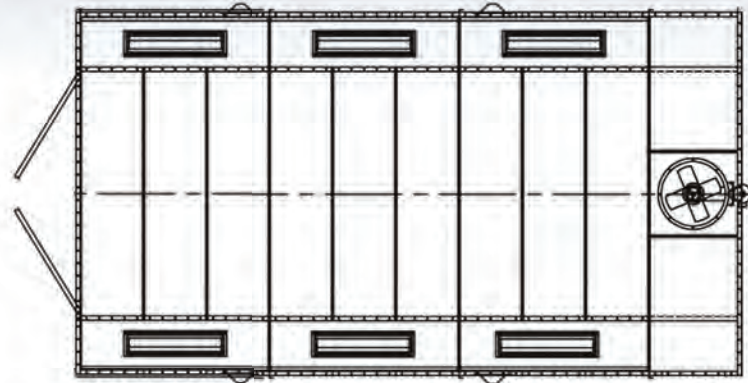

PLAN VIEW

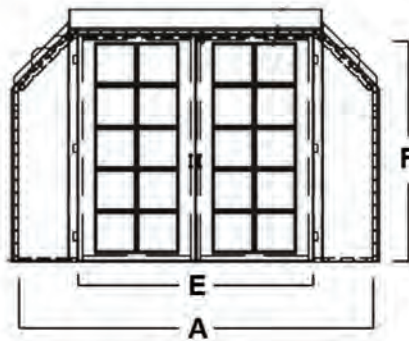

FRONT VIEW

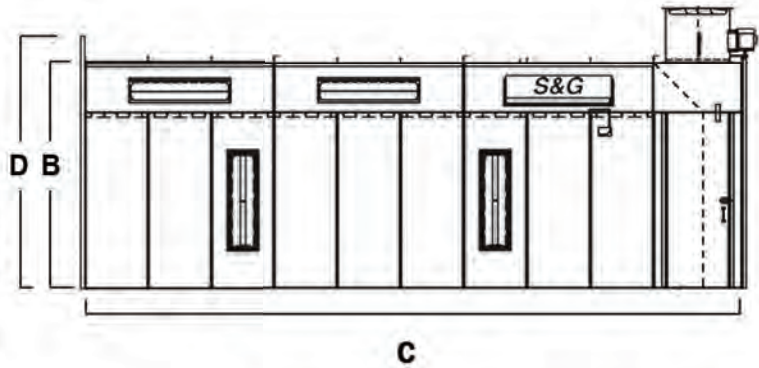

BOOTH SIDE VIEW

Model Number	Interior Dimensions			Exterior Dimensions			Access Doors	Nominal Door Opening				Lights		Air Flow SCFM	Fan Spec.		Filters	
	Width	Height	Length	Width	Height	Length		Width	Height	Qty	Type	Open	S&G		Dia.	HP	Int.	Exh.
ECC-14-09-26-N-SB	14'-0"	9'-0"	26'-0"	14'-6.5"	10'-0"	26'-4"	1	9'-4"	8'-10.5"	1	Filtered	9	1	12,600	30"	3HP	20	16
ECC-14-09-28-N-SB	14'-0"	9'-0"	28'-0"	14'-6.5"	10'-0"	28'-4"	1	9'-4"	8'-10.5"	1	Filtered	9	1	12,600	30"	3HP	20	16
ECC-14-09-30-N-SB	14'-0"	9'-0"	30'-0"	14'-6.5"	10'-0"	30'-4"	1	9'-4"	8'-10.5"	1	Filtered	9	1	12,600	30"	3HP	20	16
Reference Key	A	B	C		D			E	F									

Alternative Configurations: Reverse Flow (RF) Drive Through (DT)

Alternative Options: Pressurized (P)

Standard Length Sizing is Illustrated above

Actual Working Depth is 18 inches less than interior length.

COL-MET SPRAY BOOTHS COMPLY WITH ALL APPLICABLE OSHA AND NFPA REGULATIONS



Industrial



Auto



Wood



Air Solutions, Inc.
40 Avebury Cove
Eads, TN 38028
Ph 901-290-5090
Fx 901-290-5091

website: www.airsolutions.us

EZ MODIFIED DOWNDRAFT

- EZ TO INSTALL
- EZ TO OPERATE
- EZ TO MAINTAIN
- EZ TO PRESSURIZE
- EZ TO QUICK SHIP

BOOTH SHOWN WITH
OPTIONAL POWDER COATING
OPTIONAL PREFILTERED PLENUM

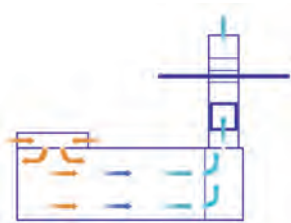

- Control panel and other electric components can be purchased separately
- ETL listed when optional control panel is added



- Industry-leading light levels
- Spray booth specific, dual voltage T-8 32-watt light fixtures
- Quality brand-name tubeaxial fans and motors
- Air solenoid valve



- Windowed personnel access doors are pre-hung in a heavy gauge galvanized steel frame for easy installation.
- Product doors are field hung on slotted hinges to facilitate installation on uneven floors

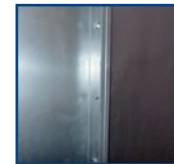

- Constructed from 18 gauge, prime-quality steel
- All panels and support members are precision punched for easy nut and bolt assembly
- 5/16" bolt with self locking nuts

OVERVIEW

The Col-Met EZ Modified Downdraft Booth intakes fresh air from the cleaner upper levels of the shop through a filter bank located in the booth ceiling near the product doors. The filtered air is drawn down through the booth to an exhaust filter system at the other end. Optional prefiltered plenum for additional intake air filtration is available. This booth also available in either drive-through or solid back configurations.

The basic modified downdraft design allows for easy pressurization with the addition of an intake plenum with fan or a heated air make up unit.

LIGHTING FEATURES

Bright, full booth illumination is provided by ten four-tube, 48", 32-watt, fluorescent light fixtures in the angled ceiling panels and side walls. Each is sealed behind clear tempered safety glass. All fixtures are UL listed and approved for their intended use and placement.



Industrial



Auto



Wood



Air Solutions, Inc.
40 Avebury Cove
Eads, TN 38028
Ph 901-290-5090
Fx 901-290-5091

website: www.airsolutions.us

EZ MODIFIED DOWNDRAFT

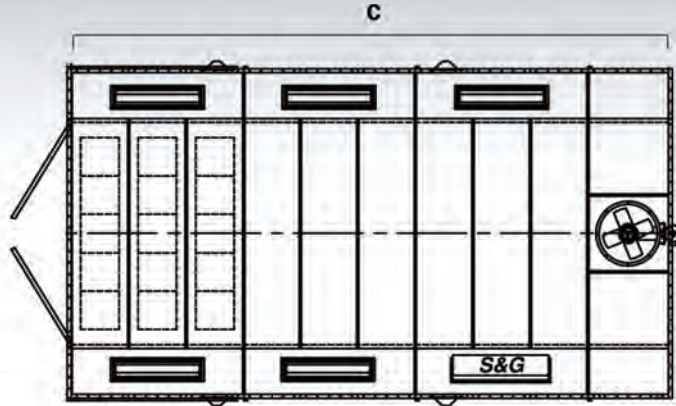

PLAN VIEW



14 GA. GALV., 3" WIDTH SUPPORT STEEL STYLE

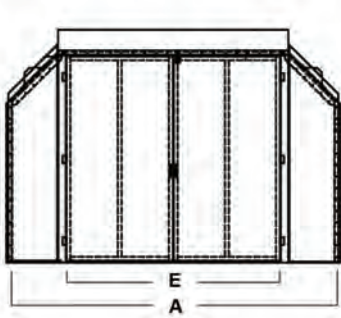

FROM BAY END

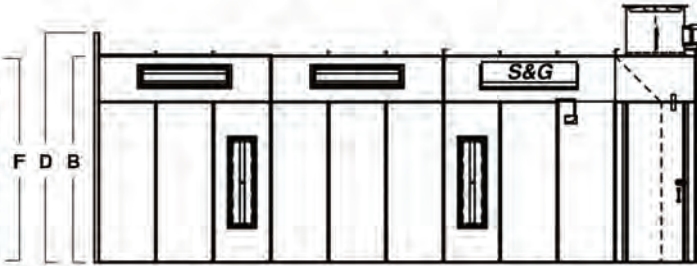

BOOTH SIDE VIEW

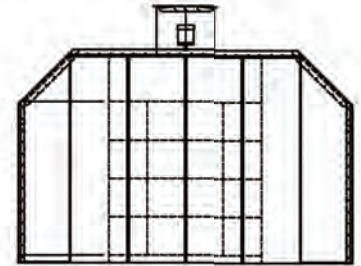

END VIEW @ CHAMBER

Model Number	Interior Dimensions			Exterior Dimensions			Access Doors	Nominal Door Opening				Lights		Air Flow SCFM	Fan Spec.		Filters	
	Width	Height	Length	Width	Height	Length		Width	Height	Qty	Type	Open	S&G		Dia.	HP	Int.	Exh.
EMD-14-09-26-N-SB	14'-0"	9'-0"	26'-0"	14'-6.5"	10'-0"	26'-4"	1	9'-4"	8'-10.5"	1	Solid	9	1	12,600	30"	3HP	15	16
EMD-14-09-28-N-SB	14'-0"	9'-0"	28'-0"	14'-6.5"	10'-0"	28'-4"	1	9'-4"	8'-10.5"	1	Solid	9	1	12,600	30"	3HP	15	16
EMD-14-09-30-N-SB	14'-0"	9'-0"	30'-0"	14'-6.5"	10'-0"	30'-4"	1	9'-4"	8'-10.5"	1	Solid	9	1	12,600	30"	3HP	15	16
Reference Key	A	B	C		D			E	F									

Alternative Configurations: Reverse Flow (RF) Drive Through (DT)

Alternative Options: Pressurized (P) Pre-Filtered (PF)

Standard Length Sizing is Illustrated above

Actual Working Depth is 18 inches less than interior length.



Industrial



Auto



Wood



Air Solutions, Inc.
40 Avebury Cove
Eads, TN 38028
Ph 901-290-5090
Fx 901-290-5091

website: www.airsolutions.us

EZ SIDE DOWNDRAFT

- EZ TO INSTALL
- EZ TO OPERATE
- EZ TO MAINTAIN
- EZ TO PRESSURIZE

BOOTH SHOWN WITH
OPTIONAL POWDER COATING

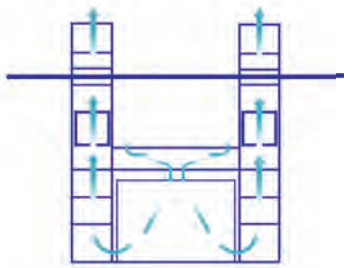

- Control panel and other electric components can be purchased separately
- ETL listed when optional when control panel is added



- Industry-leading light levels
- Spray booth specific, dual voltage T-8 32-watt light fixtures
- Quality brand-name tubeaxial fans and motors
- Air solenoid valve



- Windowed personnel access doors are pre-hung in a heavy gauge galvanized steel frame for easy installation.
- Product doors are field hung on slotted hinges to facilitate installation on uneven floors

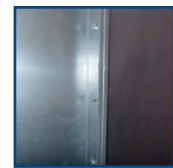

- Constructed from 18 gauge, prime-quality steel
- All panels and support members are precision punched for easy nut and bolt assembly
- 5/16" bolt with self locking nuts

OVERVIEW

The Col-Met EZ Side Downdraft Booth intakes fresh air from the cleaner upper levels of the shop through a filtered booth ceiling. The filtered air is drawn down and away from the product through exhaust filters at the floor level, along both sides. This provides efficient overspray control that reduces prep time and also provides a much healthier workplace environment without an expensive downdraft exhaust pit. This booth can also be purchased with a pre-filtered plenum or with a pressurized intake plenum, the booth can also be equipped with an air replacement unit and cure cycle to meet your requirements. This booth also available in either drive-through or solid back configurations.

LIGHTING FEATURES

Bright, full booth illumination is provided by ten four-tube, 48", 32-watt, fluorescent light fixtures in the angled ceiling panels and side walls. Each is sealed behind clear, tempered safety glass. All fixtures are UL listed and approved for their intended use and placement.



Industrial



Auto



Wood



Air Solutions, Inc.
40 Avebury Cove
Eads, TN 38028
Ph 901-290-5090
Fx 901-290-5091

website: www.airsolutions.us

EZ SIDE DOWNDRAFT

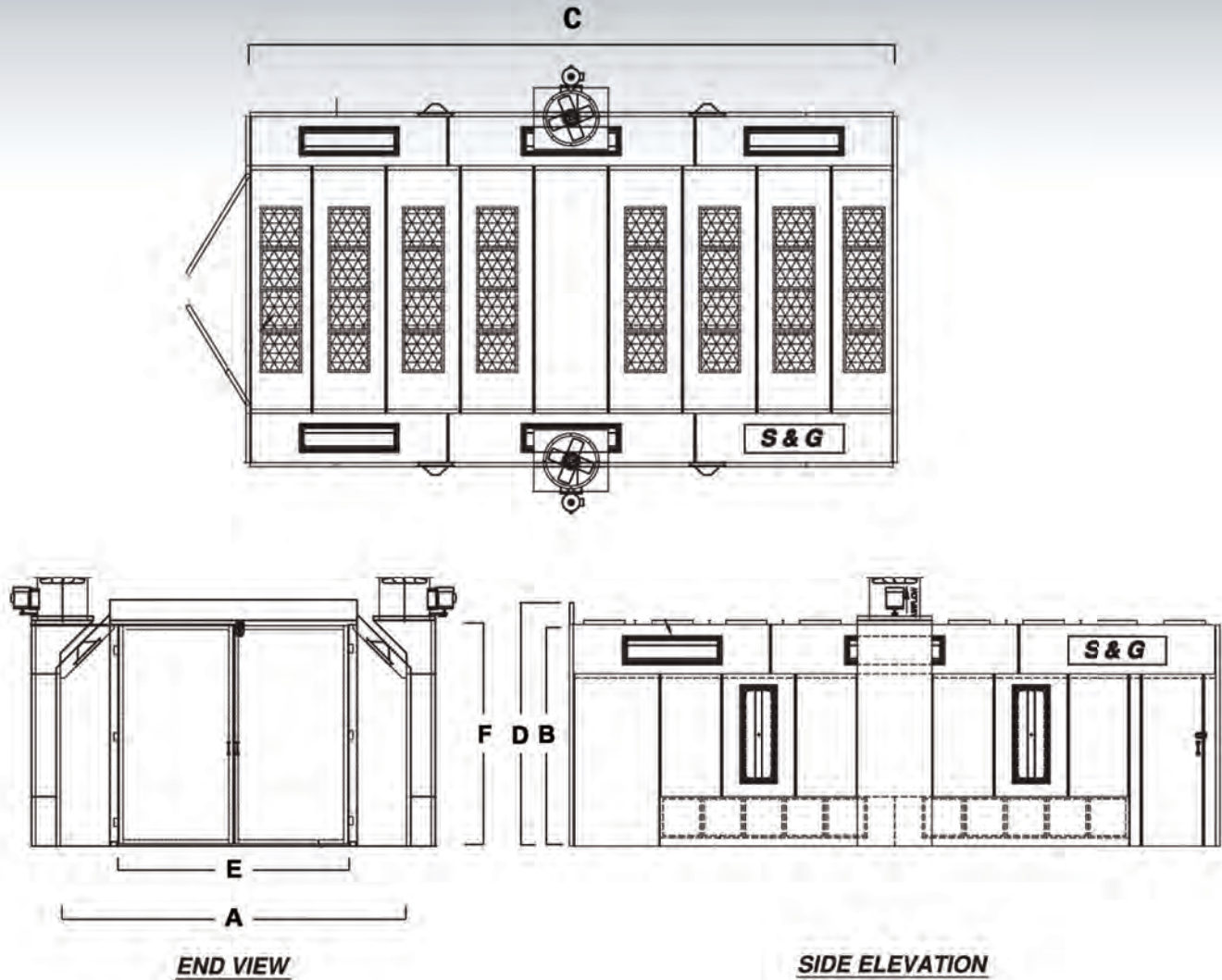

Model Number	Interior Dimensions			Exterior Dimension			Access Doors	Nominal Door Opening				Lights		Air Flow SCFM	Fan Spec.		Filters	
	Width	Height	Length	Width	Height	Length		Width	Height	Qty	Type	Open	S&G		Di.	HP	Int.	Exh.
ESD-14-09-26-N-SB	14'-0"	9'-0"	26'-0"	16'-4"	10'-0"	26'-4"	1	9'-4"	8'-10.5"	1	Solid	9	1	12,740	(2) 24"	2HP	32	20
Reference Key	A	B	C		D			E	F									

Alternative Configurations: Drive Through (DT)
Alternative Options: Pressurized (P) Pre-Filtered (PF)
Standard Length Sizing is Illustrated above



Industrial



Auto



Wood



Air Solutions, Inc.
40 Avebury Cove
Eads, TN 38028
Ph 901-290-5090
Fx 901-290-5091

website: www.airsolutions.us

EZ PIT DOWNDRAFT

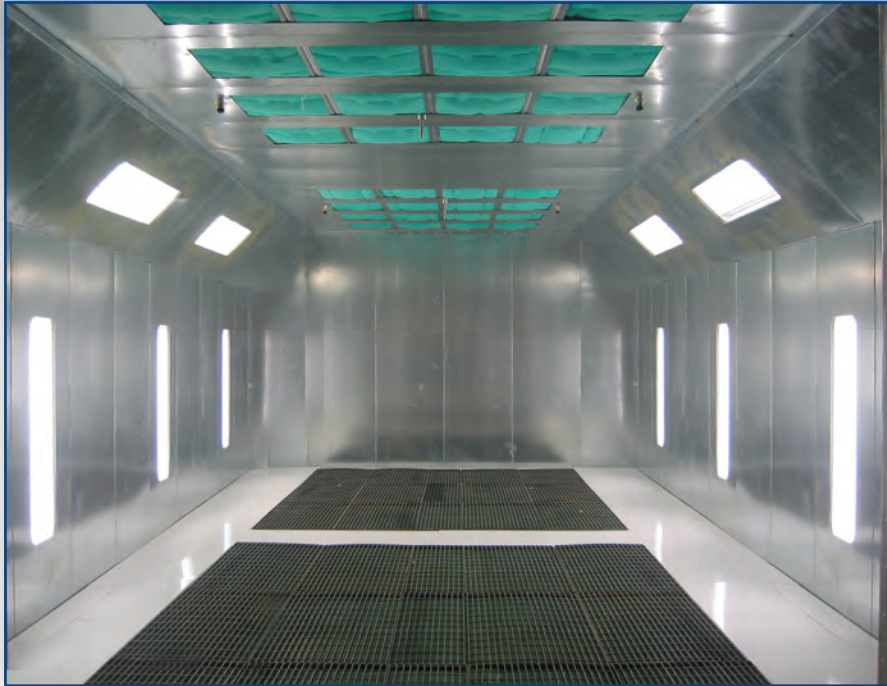

- EZ TO INSTALL
- EZ TO OPERATE
- EZ TO MAINTAIN
- EZ TO PRESSURIZE

BOOTH SHOWN WITH OPTIONAL ABOVE GROUND BASEMENT

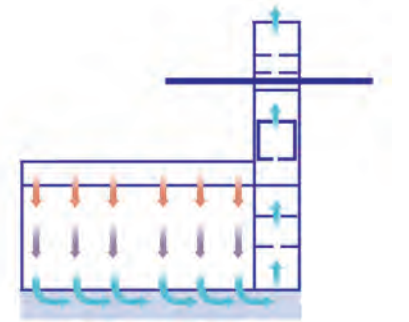

- Control panel and other electric components can be purchased separately
- ETL listed when optional when control panel is added



- Industry-leading light levels
- Spray booth specific, dual voltage T-8 32-watt light fixtures
- Quality brand-name tubeaxial fans and motors
- Air solenoid valve



- Windowed personnel access doors are pre-hung in a heavy gauge galvanized steel frame for easy installation.
- Product doors are field hung to facilitate installation on uneven floors

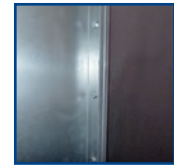

- Constructed from 18 gauge, prime-quality steel
- All panels and support members are precision punched for easy nut and bolt assembly
- 5/16" bolt with self locking nuts

OVERVIEW

The EZ Pit Downdraft Booth takes in fresh air from the cleaner upper levels of the shop, through a filtered booth ceiling. The filtered air is drawn down and away from the product through exhaust filters in the pit located in the floor. This provides efficient overspray control that reduces prep time and also provides a much healthier workplace environment. An optional above ground basement exhaust plenum is available for installation without concrete work.

This booth can be purchased with a pre-filtered plenum or with a pressurized intake plenum. It can also be equipped with an air replacement unit and cure cycle to meet your requirements. The EZ Pit Downdraft Booth is available in either drive-through or solid back configurations.

LIGHTING FEATURES

Bright, full booth illumination is provided by ten four-tube, 48", 32-watt fluorescent light fixtures in the angled ceiling panels and side walls. Each is sealed behind clear tempered safety glass. All fixtures are UL listed and approved for their intended use and placement.



Industrial



Auto



Wood



Air Solutions, Inc.
40 Avebury Cove
Eads, TN 38028
Ph 901-290-5090
Fx 901-290-5091

website: www.airsolutions.us

EZ PIT DOWNDRAFT

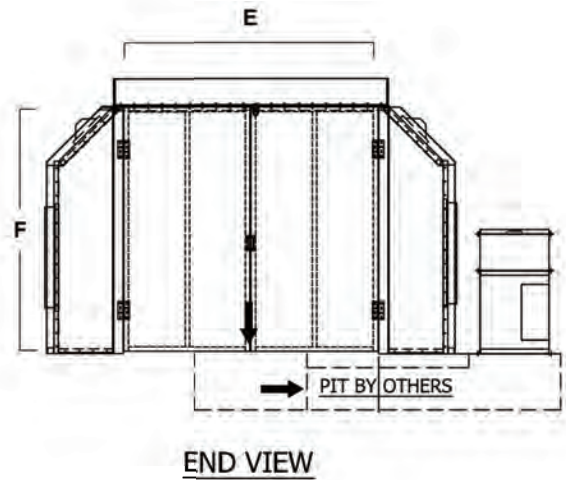
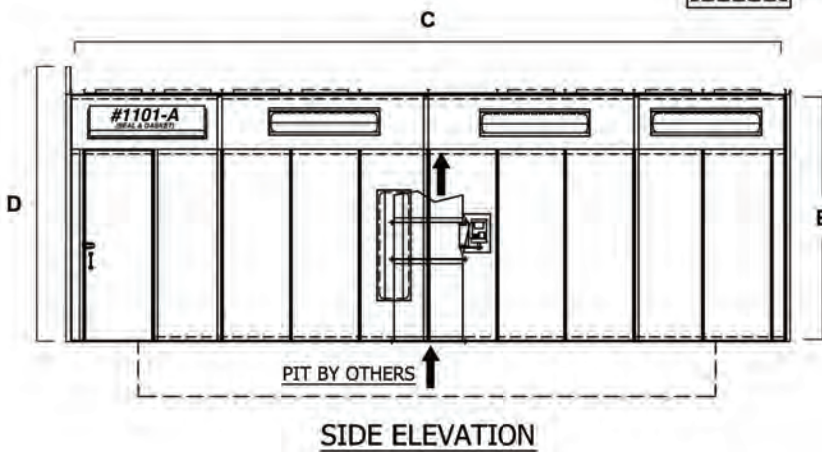
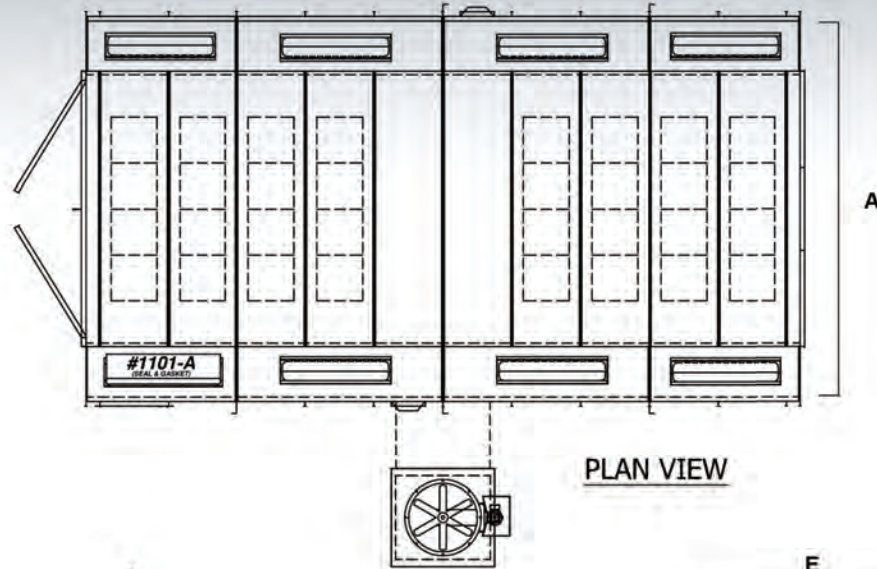

Model Number	Interior Dimensions			Exterior Dimensions			Access Doors	Nominal Door Opening		Illumination S&G	Air Flow SCFM	Fan Spec.		Filters						
	Width	Height	Length	Width	Height	Length		Width	Height			Open	Total	HP	Int.	Exh.				
EPD-14-09-26-N-SB	14'-0"	9'-0"	26'-0"	14'-10.5"	10'-0"	26'-4"	1	9'-4"	8'-10.5"	1	Solid	1	9	10	12,740	30"	3 HP	32	24	
Reference Key	A	B	C		D			E	F											

Alternative Configurations: Drive Through (DT)
Alternative Options: Pressurized (P) Pre-Filtered (PF)
Standard Length Sizing is Illustrated above